

PL-500 Dumps

Microsoft Power Automate RPA Developer

<https://www.certleader.com/PL-500-dumps.html>



NEW QUESTION 1

- (Exam Topic 1)

You need to configure permissions for the Purchase order quantity flow. Which permission should you assign?

- A. Co-owner
- B. Run-only user
- C. Owner
- D. User

Answer: D

NEW QUESTION 2

- (Exam Topic 1)

You need to determine the causes for the reported issues.

What are the causes? To answer, select the appropriate options in the answer area. NOTE: Each correct selection is worth one point.

Answer Area

Issue	Cause
New environment	<div>Flow checker did not run.</div> <div>Admin mode is turned on.</div> <div>Admin mode is turned off.</div> <div>A connector was added to a DLP policy.</div>
FlowA	<div>The user is in the wrong environment.</div> <div>The user does not have the correct permissions.</div>
Dataverse error	<div>There is no Microsoft Dataverse database provisioned.</div> <div>The user did not sign into Power Automate by using a Microsoft work account.</div> <div>Microsoft Dataverse was not shared with the user from the development environment.</div>

- A. Mastered
- B. Not Mastered

Answer: A

Explanation:

Answer Area

Issue	Cause
New environment	<div>Flow checker did not run.</div> <div>Admin mode is turned on.</div> <div>Admin mode is turned off.</div> <div>A connector was added to a DLP policy.</div>
FlowA	<div>The user is in the wrong environment.</div> <div>The user does not have the correct permissions.</div>
Dataverse error	<div>There is no Microsoft Dataverse database provisioned.</div> <div>The user did not sign into Power Automate by using a Microsoft work account.</div> <div>Microsoft Dataverse was not shared with the user from the development environment.</div>

NEW QUESTION 3

- (Exam Topic 2)

You need to address the issue with the capacity planning flow. What should you do?

- A. Increase the CPU and memory of the machine on which the gateway is hosted.
- B. Create a gateway cluster.
- C. Configure the system to send alerts when the gateway fails.
- D. Create a machine group and add machines to the group to handle requests.

Answer: D

NEW QUESTION 4

- (Exam Topic 2)

You need to configure the desktop action for the MaintenanceScheduler cloud flow. Which two actions should you perform? Each correct answer presents part of the solution. NOTE: Each correct selection is worth one point.

- A. Select machine settings in Power Automate for desktop.
- B. Select the Timeout property and update the duration to PT20M.
- C. Select the Timeout property and update the duration to P20M.
- D. Launch Power Automate for desktop.
- E. Navigate to Desktop flow action settings in the cloud flow.

Answer: AD

NEW QUESTION 5

- (Exam Topic 2)

You need to configure the RailStatusUpdater cloud flow. What should you do?

- A. Create a JavaScript function to update the run mode values of each action within the desktop flow.
- B. Create an environment variabl
- C. Update each desktop flow action to read the variable.
- D. Manually update each desktop flow action to change the run mode.
- E. Create a desktop flow to update the run mode values of each action within the cloud flow.

Answer: A

NEW QUESTION 6

- (Exam Topic 2)

You need to identify the actions that PipelineManager1 can perform.

Which three actions can PipelineManager1 perform? Each correct answer presents a complete solution. NOTE: Each correct selection is worth one point.

- A. Override the DLP policy.
- B. Modify or delete a flow.
- C. Modify the owner's connection credentials.
- D. View the run history.
- E. Set the cloud flow priority.
- F. Add or remove other owners.

Answer: CDF

NEW QUESTION 7

- (Exam Topic 2)

You need to package the automations. What should you do?

- A. Show dependencies within the solution.
- B. Remove unmanaged layers.
- C. Add required components to each item within the solution.
- D. Add existing components to the solution.

Answer: B

NEW QUESTION 8

- (Exam Topic 3)

You plan to implement a data loss prevention (DLP) policy for a production environment. You need to define the policy.

Which four actions should you perform in sequence? To answer, move the appropriate actions from the list of actions to the answer area and arrange them in the correct order.

The screenshot shows a user interface for configuring a DLP policy. On the left, under the heading "Actions", there is a list of six actions in rectangular boxes: "Define the scope and add all environments to the policy.", "Classify and assign connectors.", "Review and create the policy.", "Define the scope and add the environment to the policy.", "Name the policy.", and "Add new tenant rules.". To the right of this list are two circular buttons with arrows: a right-pointing arrow (>) and a left-pointing arrow (<). On the far right, under the heading "Answer area", there is a large empty rectangular box for the user to place the selected actions in the correct sequence.

- A. Mastered
- B. Not Mastered

Answer: A

Explanation:

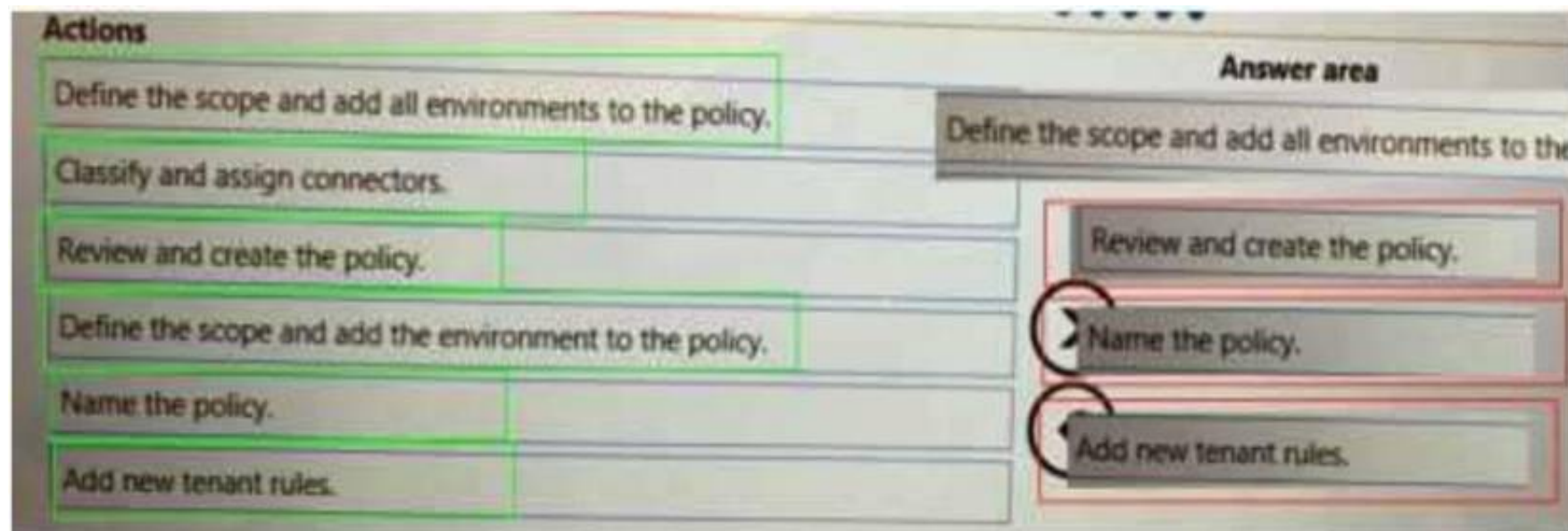

NEW QUESTION 9

- (Exam Topic 3)

You are developing automation solutions for a company. You need to use an environment variable in a cloud flow.

Which three actions should you perform in sequence? To answer, move the appropriate actions from the list of actions to the order.

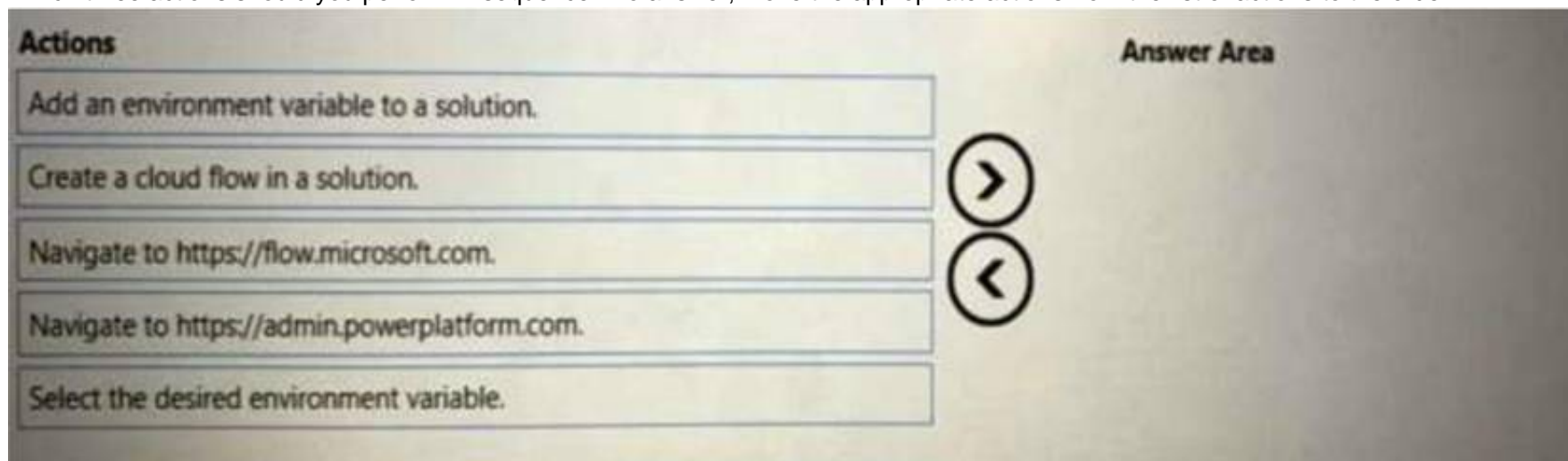

- A. Mastered
- B. Not Mastered

Answer: A

Explanation:

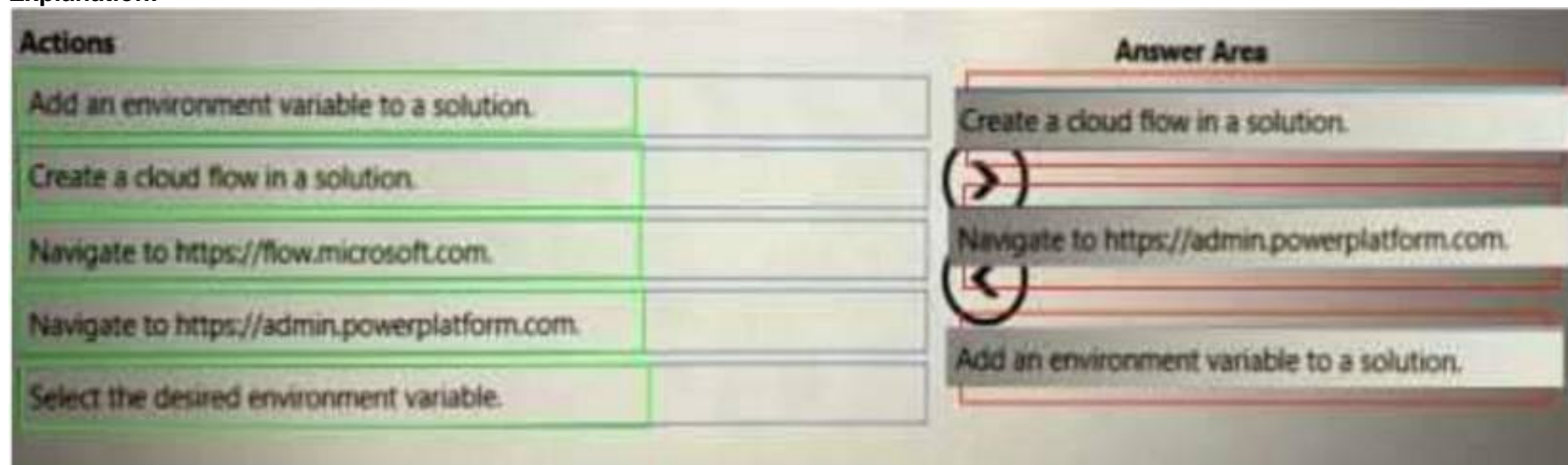

NEW QUESTION 10

- (Exam Topic 3)

You develop automation solutions for a company. You need to share the solutions with other users.

Which actions should you use? To answer, select the appropriate options in the answer area. NOTE: Each correct selection is worth one point.

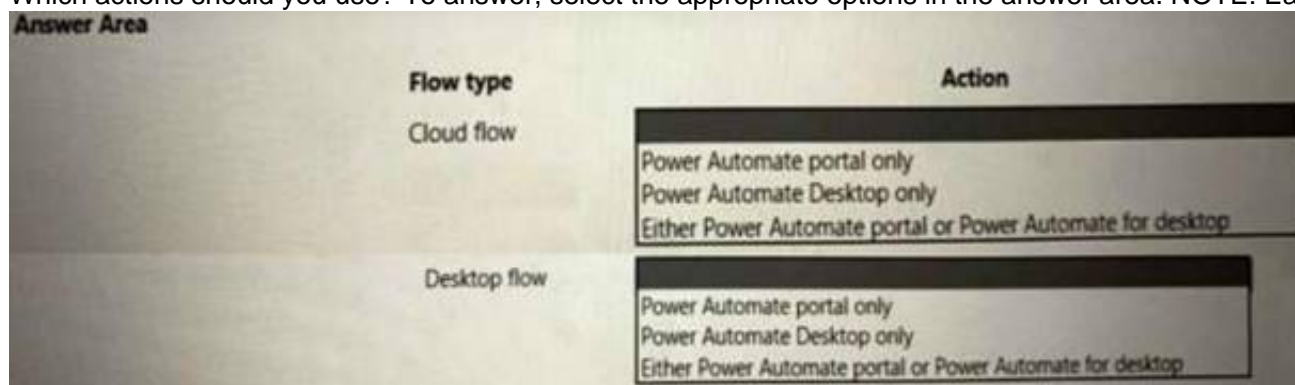

- A. Mastered

B. Not Mastered

Answer: A

Explanation:

Flow type	Action
Cloud flow	<div>Power Automate portal only</div> <div>Power Automate Desktop only</div> <div>Either Power Automate portal or Power Automate for desktop</div>
Desktop flow	<div>Power Automate portal only</div> <div>Power Automate Desktop only</div> <div>Either Power Automate portal or Power Automate for desktop</div>

NEW QUESTION 10

- (Exam Topic 3)

A company publishes a list of contacts each day as an HTML table on a web page. The company has a customer relationship management (CRM) application that runs on employee desktop devices.

You need to implement an RPA solution that reads data from the HTML table and create records in the CRM application.

Which four actions should you perform in sequence? To answer, move the appropriate actions from the list of actions to the answer area and arrange them in the correct order.

Actions

Launch a new web browser instance.

Use the Get details of element on web page action to read data from the HTML table into a variable.

Use the Run application action to start the CRM application.

Use the Extract data from web page action to read data from the HTML table into a variable.

Use a dynamic selector to save data from the HTML table into a variable.

Use a For each loop to write data from the variable to the CRM application.

Answer area

>

<

A. Mastered

B. Not Mastered

Answer: A

Explanation:

Actions

Launch a new web browser instance.

Use the Get details of element on web page action to read data from the HTML table into a variable.

Use the Run application action to start the CRM application.

Use the Extract data from web page action to read data from the HTML table into a variable.

Use a dynamic selector to save data from the HTML table into a variable.

Use a For each loop to write data from the variable to the CRM application.

Answer area

Use the Get details of element on web page action to read data from the HTML table into a variable.

Use the Extract data from web page action to read data from the HTML table into a variable.

Use a For each loop to write data from the variable to the CRM application.

Launch a new web browser instance.

NEW QUESTION 14

- (Exam Topic 3)

You develop automation solutions for a company. You need to package the solutions.

What should you use? To answer, select the appropriate options in the answer area. NOTE: Each correct selection is worth one point.

Requirement	Solution type
Share the solution with a colleague who uses a personal development environment.	<div>managed</div> <div>unmanaged</div>
Deploy the final solution to a production environment and prevent further development.	<div>managed</div> <div>unmanaged</div>

- A. Mastered
- B. Not Mastered

Answer: A

Explanation:

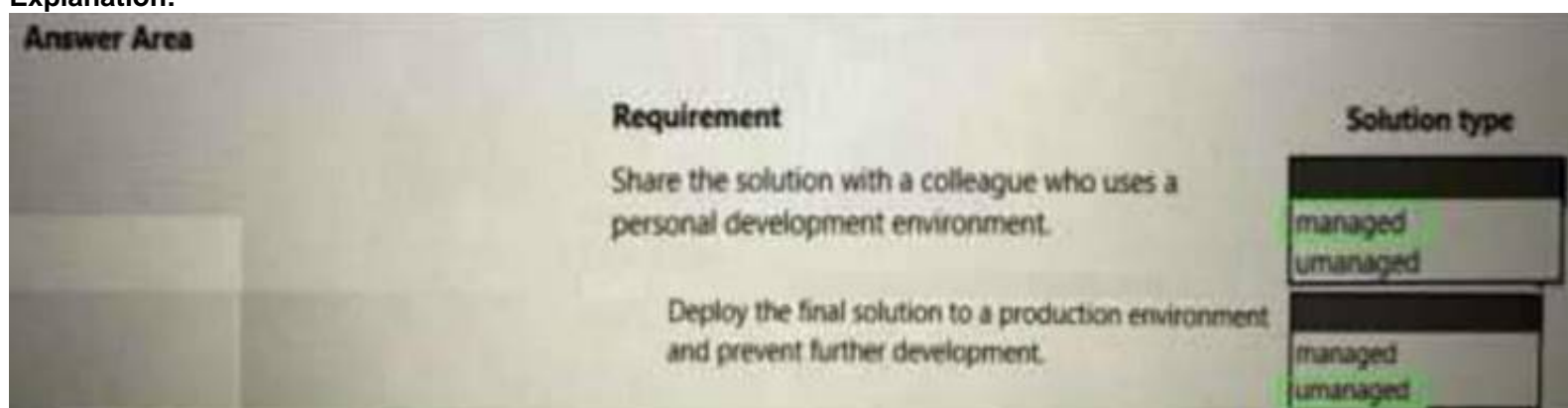

NEW QUESTION 19

- (Exam Topic 3)

You are developing a custom connector.

You need to create the definition for the connector.

Which features should you use? To answer, select the appropriate options in the answer area. NOTE: Each correct selection is worth one point.

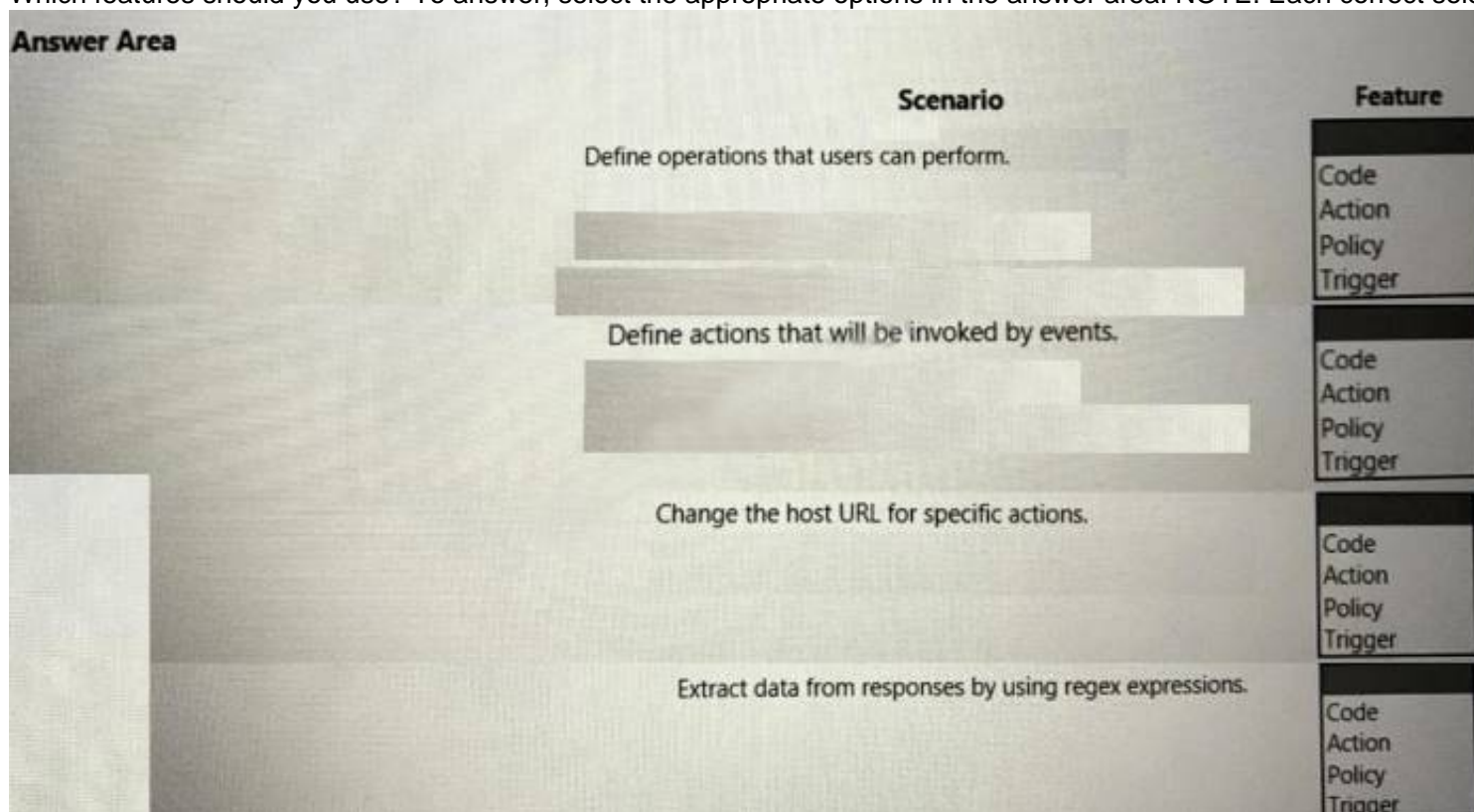

- A. Mastered
- B. Not Mastered

Answer: A

Explanation:

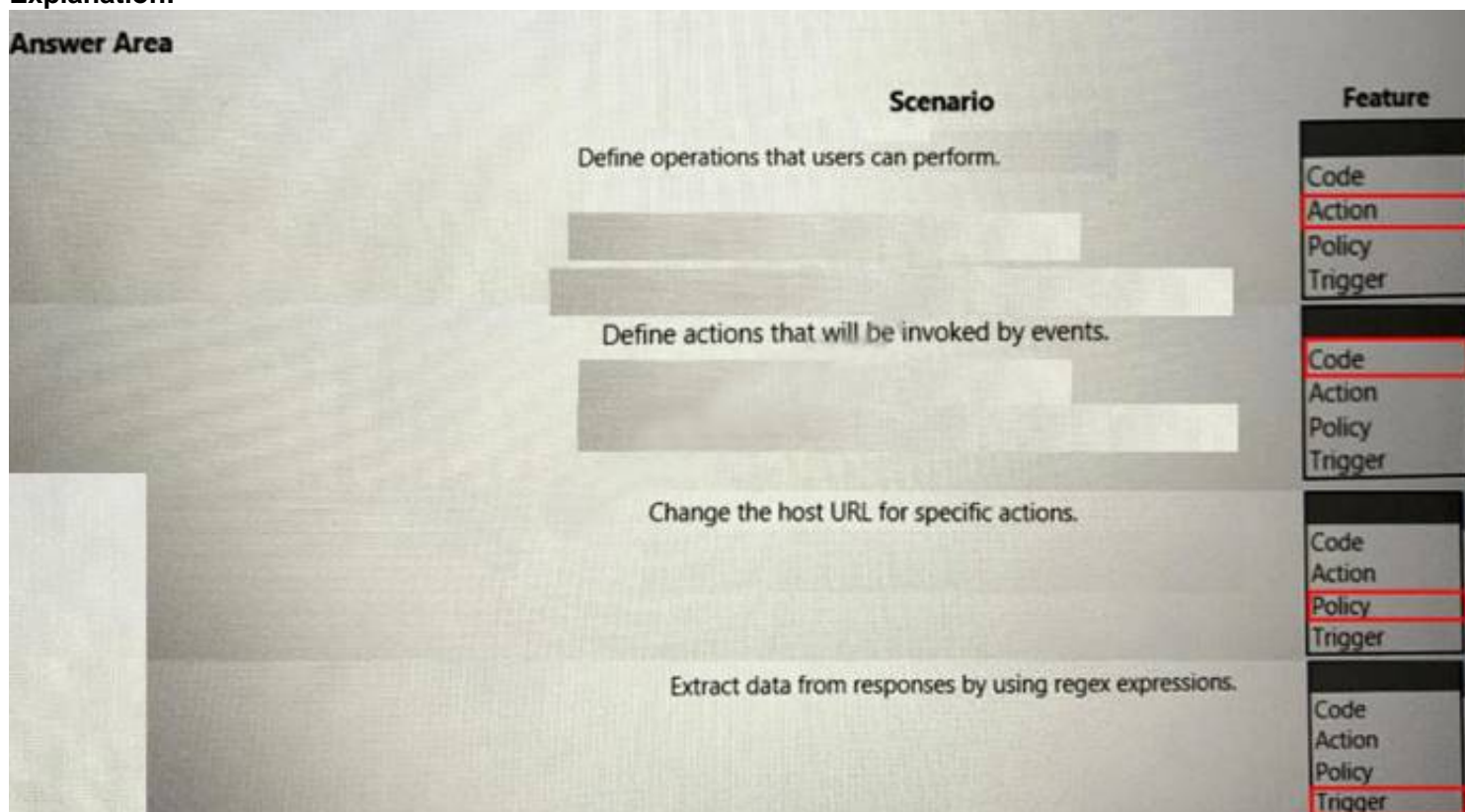

NEW QUESTION 20

- (Exam Topic 3)

You are creating an automation for a company. When a new record is created in a Microsoft Dataverse table, the automation must add the same data to an enterprise resource planning (ERP) system. The ERP system does not have an API.

You need to create the automation solution.

What should you use? To answer, select the appropriate options in the answer area. NOTE: Each correct selection is worth one point.

Requirement	Solution
Trigger an automation to run when the new record is created.	<div>Cloud flow</div> <div>Desktop flow</div> <div>Model-driven app</div>
Add the data to the ERP system.	<div>Cloud flow</div> <div>Desktop flow</div> <div>Model-driven app</div>

- A. Mastered
- B. Not Mastered

Answer: A

Explanation:

Requirement	Solution
Trigger an automation to run when the new record is created.	<div>Cloud flow</div> <div>Desktop flow</div> <div>Model-driven app</div>
Add the data to the ERP system.	<div>Cloud flow</div> <div>Desktop flow</div> <div>Model-driven app</div>

NEW QUESTION 21

- (Exam Topic 3)

You are developing automation solutions for a company.

You need to use Microsoft Office scripts in a cloud flow to calculate the number of business days between two dates.

Which three actions should you perform in sequence?

To order, answer, move the appropriate actions from the list of actions to the answer area and arrange them in the correct order.

Actions	Answer area
In the Excel desktop app, navigate to the Automate tab.	
Create and save a script.	
Add and configure a Run script action.	
Add a Compose action and use an expression.	
In Microsoft Excel on the web, navigate to the Automate tab.	

- A. Mastered
- B. Not Mastered

Answer: A

Explanation:

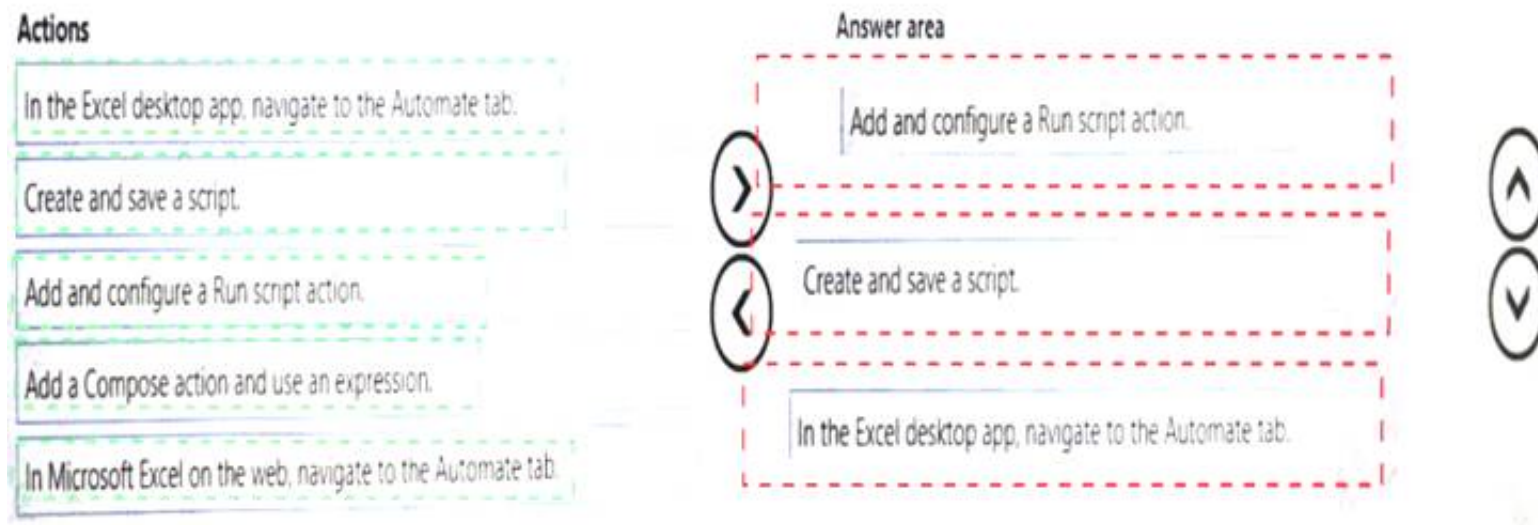

NEW QUESTION 26

- (Exam Topic 3)

You develop a desktop flow. You need to debug the flow.

Which three tools can you use? Each correct answer presents a complete solution. NOTE: Each correct selection is worth one point.

- A. Static results
- B. Run from here
- C. Breakpoints
- D. Configure run after
- E. Run next action

Answer: BCE

NEW QUESTION 27

- (Exam Topic 3)

You have a flow that interacts with different SharePoint sites. You add the flow to a solution.

You redeploy the solution to production each time you make a change to the flow. You do not want to change the SharePoint site URL every time you redeploy the solution.

You need to configure the solution. Which solution component should you use?

- A. Environment variable
- B. Web resource
- C. Managed identity
- D. Connection reference

Answer: D

NEW QUESTION 29

- (Exam Topic 3)

You create a Microsoft Power Platform solution. You create variables to define input values for the flow. You export the solution as managed and import the solution into a user acceptance testing (UAT) environment.

The flow in the UAT environment is still using the values from the development (DEV) environment.

You need to resolve the issue.

Which four actions should you perform in sequence? To answer, move the appropriate actions from the list of actions to the answer area and arrange them in the correct order.

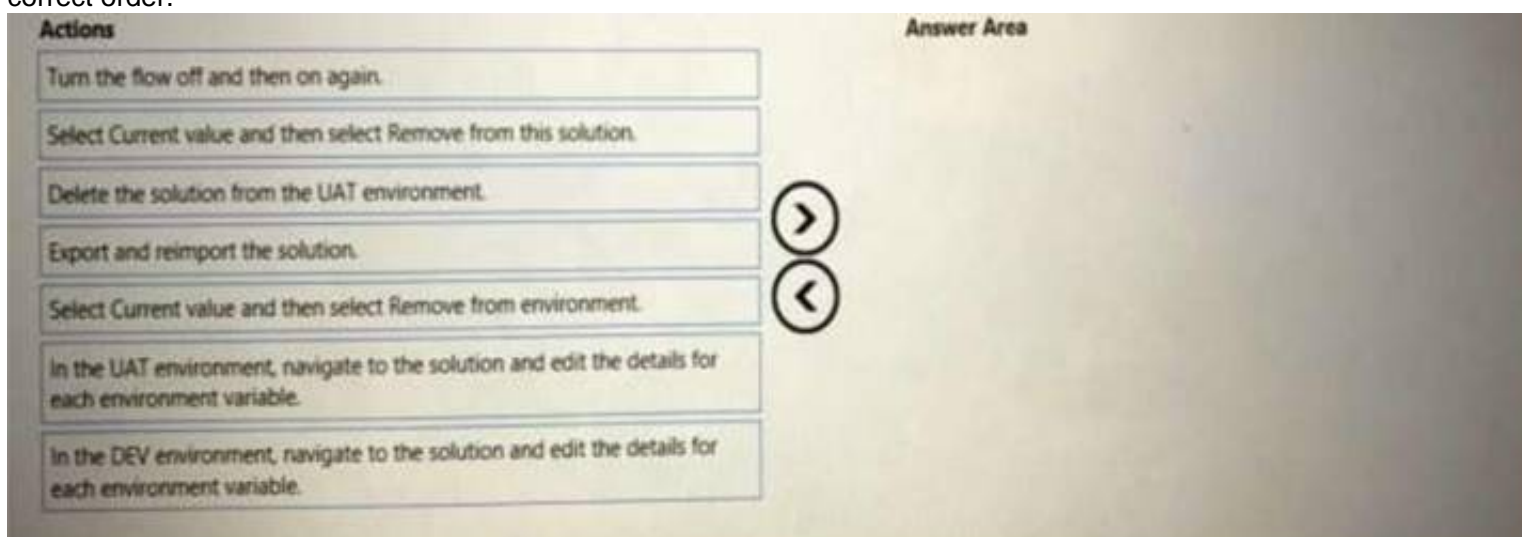

- A. Mastered
- B. Not Mastered

Answer: A

Explanation:

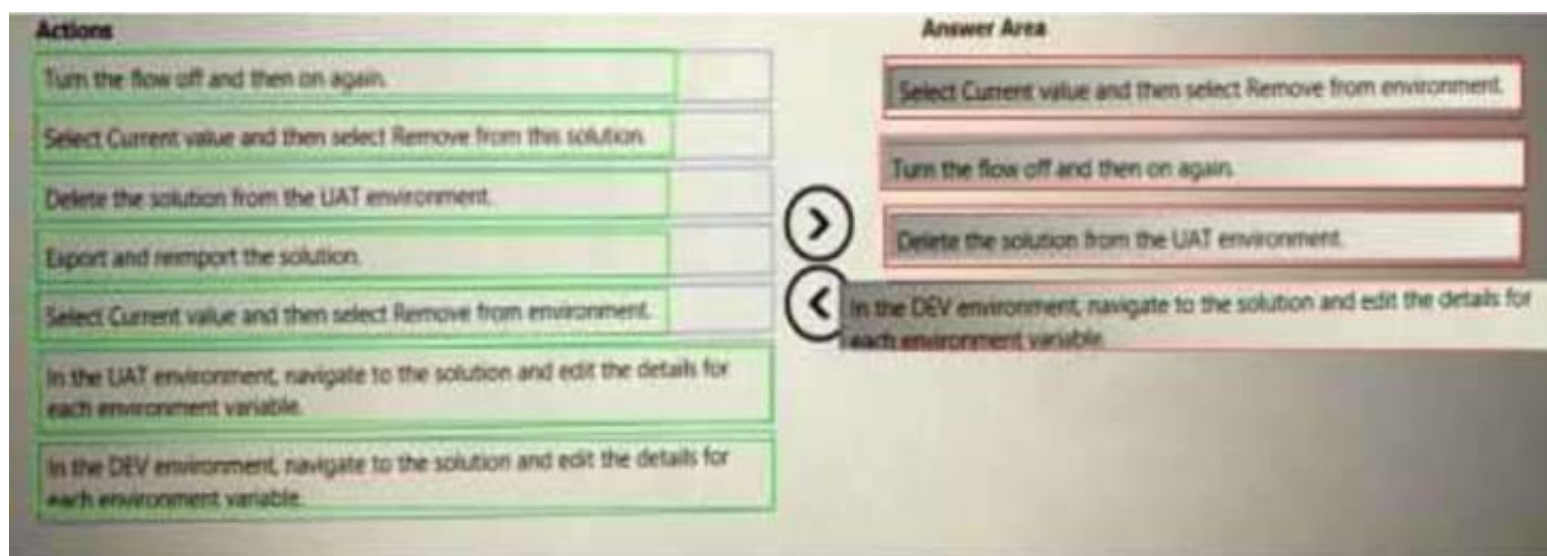

NEW QUESTION 33

- (Exam Topic 3)

You are developing automation solutions for a company.

You need to select the appropriate error handling action for the following scenarios. Which actions should you use? To answer, select the appropriate options in the answer area. NOTE: Each correct selection is worth one point.

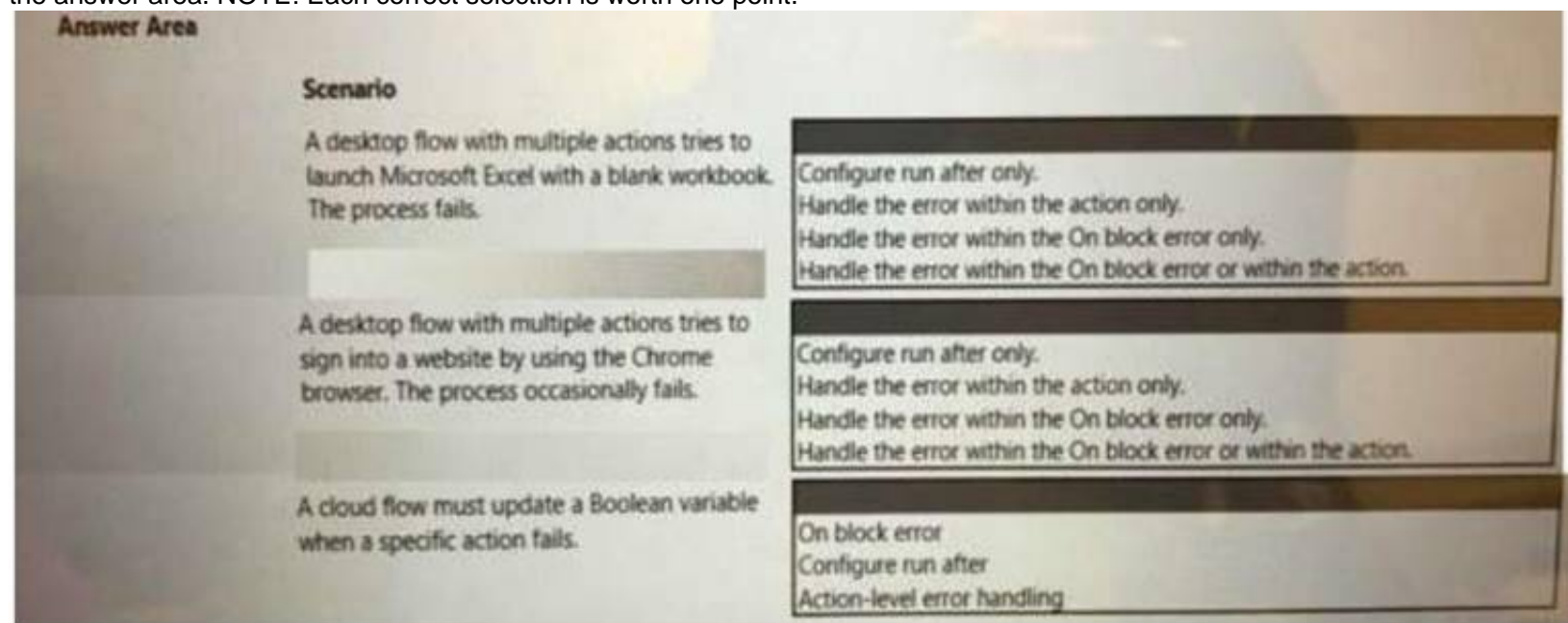

A. Mastered

B. Not Mastered

Answer: A

Explanation:

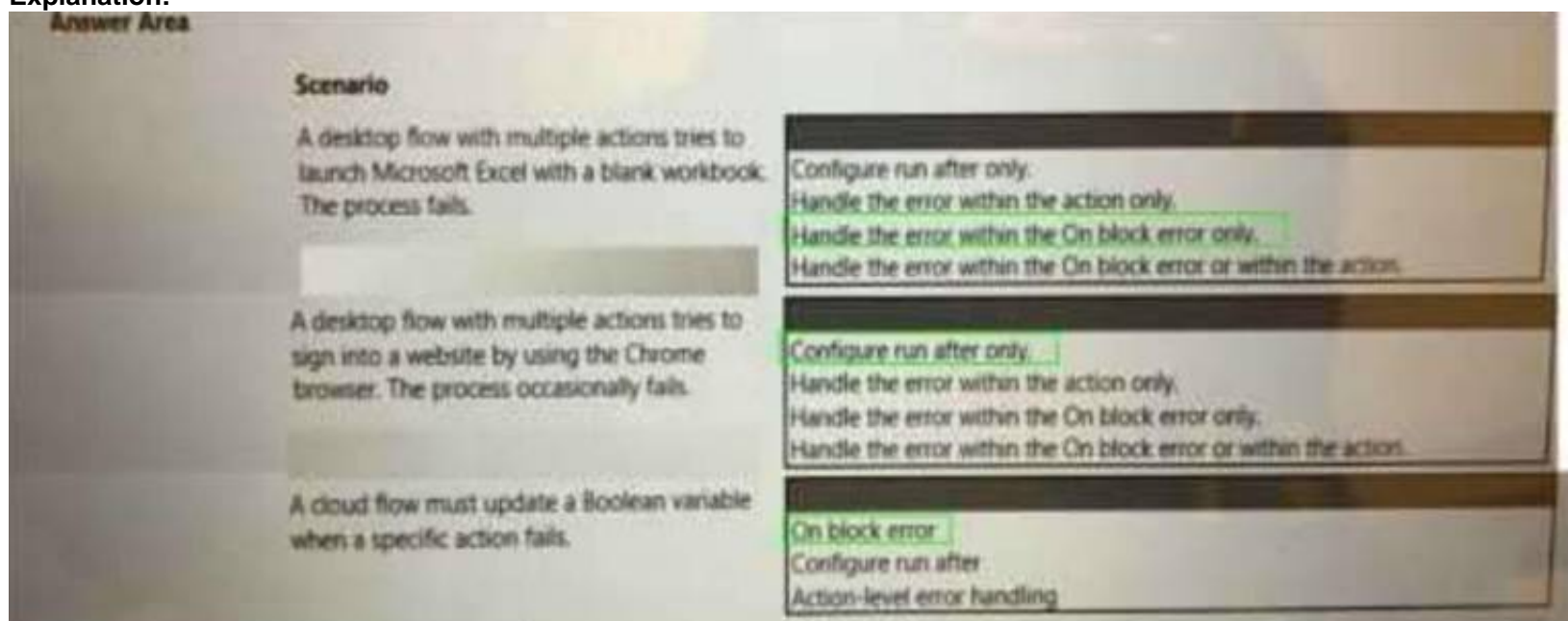

NEW QUESTION 38

- (Exam Topic 3)

You develop automation solutions for a company.

You need to implement actions to meet the company's requirements.

What should you do? To answer, select the appropriate options in the answer area. NOTE: Each correct selection is worth one point.

Answer Area		
Scenario	Requirement	Action
You have a desktop flow that is currently in queue.	You must ensure that the flow is the next flow to run.	<div>Move to the top</div> <div>Change the priority</div> <div>Cancel and resubmit the flow</div>
You have a business-critical desktop flow that runs on a virtual machine. The virtual machine also handles multiple ad-hoc desktop flows.	You must ensure that the business-critical flow runs when it is needed.	<div>Change the priority</div> <div>Move to the top</div> <div>Created a scheduled trigger</div>

- A. Mastered
B. Not Mastered

Answer: A

Explanation:

Answer Area		
Scenario	Requirement	Action
You have a desktop flow that is currently in queue.	You must ensure that the flow is the next flow to run.	<div>Move to the top</div> <div>Change the priority</div> <div>Cancel and resubmit the flow</div>
You have a business-critical desktop flow that runs on a virtual machine. The virtual machine also handles multiple ad-hoc desktop flows.	You must ensure that the business-critical flow runs when it is needed.	<div>Change the priority</div> <div>Move to the top</div> <div>Created a scheduled trigger</div>

NEW QUESTION 41

- (Exam Topic 3)

You develop Power Automate flows for a company. You need to help users locate and run the flows. Where should you direct users to find the flows? To answer NOTE: Each correct selection is worth one point.

Answer Area	
Requirement	Value
You select the Send a copy button from the flow portal to send the flow to a business user group.	<div>the Solutions page</div> <div>the Shared with me tab of the My flows page</div> <div>the Shared with me tab of the Templates page</div>
You select the Share button from the portal to share the flow with business users.	<div>the Solutions page</div> <div>the Shared with me tab of the My flows page</div> <div>the Shared with me tab of the Templates page</div>

- A. Mastered
B. Not Mastered

Answer: A

Explanation:

Answer Area	
Requirement	Value
You select the Send a copy button from the flow portal to send the flow to a business user group.	<div>the Solutions page</div> <div>the Shared with me tab of the My flows page</div> <div>the Shared with me tab of the Templates page</div>
You select the Share button from the portal to share the flow with business users.	<div>the Solutions page</div> <div>the Shared with me tab of the My flows page</div> <div>the Shared with me tab of the Templates page</div>

NEW QUESTION 43

- (Exam Topic 3)

You are creating automation solutions for a company. You create a cloud flow that includes a Scope action. What is the purpose of the Scope action?

- A. Run a group of actions based on conditional input.

- B. Group actions together and ensure that all actions succeed or fail as a group.
- C. Run a group of actions based on input from a switch statement
- D. Terminate a flow run.

Answer: A

NEW QUESTION 48

- (Exam Topic 3)

A company has an unattended cloud flow solution. The solution includes a desktop flow that runs on a virtual machine.

The company reports that the cloud flow processes more transactions per day than the planned capacity.

You need to scale the solution to keep up with demand.

Which four actions should you perform in sequence? To answer, move the appropriate actions from the list of actions to the answer area and arrange them in the correct order.

Actions

- Provision virtual machines.
- Register the machines to the correct environment by using flow.microsoft.com.
- Add the machines to a machine group.
- Register the machines to the correct environment by using the machine runtime application.
- Update the machine connections to target the machine group in the cloud flow.
- Update the machine connections to target the machine group in the desktop flow.

>

<

Answer Area

^

v

- A. Mastered
- B. Not Mastered

Answer: A

Explanation:

Actions

- Provision virtual machines.
- Register the machines to the correct environment by using flow.microsoft.com.
- Add the machines to a machine group.
- Register the machines to the correct environment by using the machine runtime application.
- Update the machine connections to target the machine group in the cloud flow.
- Update the machine connections to target the machine group in the desktop flow.

>

<

Answer Area

Update the machine connections to target the machine group in the cloud flow.

Provision virtual machines.

Add the machines to a machine group.

Update the machine connections to target the machine group in the desktop flow.

^

v

NEW QUESTION 53

- (Exam Topic 3)

You create several desktop flows. Each flow will run on a single user's device. You need to determine how Power Automate will orchestrate the flows.

Which three rules will Power Automate apply? Each correct answer presents a complete solution. NOTE: Each correct selection is worth one point.

- A. All the flows are run simultaneously.
- B. The next flow will run when each run completes based on the priority and the time requested.
- C. The first flow runs on the target device based on the priority and the time requested.
- D. The first flow runs on the target device based on Next to run status and time requested.
- E. The first and last flows run based on the priority and the time requested.
- F. The remaining flows are queued.

Answer: AEF

NEW QUESTION 58

- (Exam Topic 3)

You must create new flows within a solution and import existing flows into the solution. You need to configure the solution.

Which three actions can you perform? Each correct answer presents a complete solution. NOTE: Each correct selection is worth one point.

- A. Create the flows within the solution to automatically create connection references.
- B. Add credential information to each connection reference.
- C. Modify each trigger and action when you add a flow into the solution to use connection references
- D. Select connections for connection references when you import solutions into an environment
- E. Add an existing connection reference into the solution in the same environment.

Answer: ADE

NEW QUESTION 61

- (Exam Topic 3)

You are developing a cloud flow.

The flow must be able to query several Azure endpoints and must use standard actions where possible. You need to configure the flow.

Which actions should you use? To answer, select the appropriate options in the answer area. NOTE: Each correct selection is worth one point.

Answer Area	
Requirement	Action
Issue POST requests to the Microsoft Graph API by using application permissions.	HTTP HTTP with Azure AD Send an HTTP request to SharePoint Office 365 groups send an HTTP request
Issue GET requests to the Microsoft Graph API by using delegated permissions.	HTTP HTTP with Azure AD Send an HTTP request to SharePoint Office 365 groups send an HTTP request
Issue POST requests to Office 365 Management APIs by using delegated permissions.	HTTP HTTP with Azure AD Send an HTTP request to SharePoint Office 365 groups send an HTTP request
Issue GET requests to the SharePoint REST API by using delegated permissions.	HTTP HTTP with Azure AD Send an HTTP request to SharePoint Office 365 groups send an HTTP request
Issue POST requests to SharePoint REST API by using application permissions.	HTTP HTTP with Azure AD Send an HTTP request to SharePoint Office 365 groups send an HTTP request

- A. Mastered
- B. Not Mastered

Answer: A

Explanation:

Answer Area	
Requirement	Action
Issue POST requests to the Microsoft Graph API by using application permissions.	HTTP HTTP with Azure AD Send an HTTP request to SharePoint Office 365 groups send an HTTP request
Issue GET requests to the Microsoft Graph API by using delegated permissions.	HTTP HTTP with Azure AD Send an HTTP request to SharePoint Office 365 groups send an HTTP request
Issue POST requests to Office 365 Management APIs by using delegated permissions.	HTTP HTTP with Azure AD Send an HTTP request to SharePoint Office 365 groups send an HTTP request
Issue GET requests to the SharePoint REST API by using delegated permissions.	HTTP HTTP with Azure AD Send an HTTP request to SharePoint Office 365 groups send an HTTP request
Issue POST requests to SharePoint REST API by using application permissions.	HTTP HTTP with Azure AD Send an HTTP request to SharePoint Office 365 groups send an HTTP request

NEW QUESTION 62

- (Exam Topic 3)

You plan to use a cloud flow.

The flow must be contained within a solution. You need to add the cloud flow to a solution.

Solution: Create an instant cloud flow outside of a solution. Add the cloud flow into a new unmanaged solution. Does the solution meet the goal?

- A. Yes
- B. No

Answer: A

NEW QUESTION 66

- (Exam Topic 3)
You have a Microsoft Dataverse table in a solution. You delete fields from the table.
You need to automatically delete the fields from the Microsoft Dataverse table when you import the updated solution into a target environment
Which import option should you use?

- A. Stage for upgrade
- B. Update
- C. Upgrade

Answer: C

NEW QUESTION 69

- (Exam Topic 3)
You develop automation solutions for a company.
When a new record is added to a Microsoft Dataverse table, the solution must add the contents of the record to a Microsoft Word Online (Business) template The solution must convert the template to a PDF document and email the PDF document to a stakeholder.
You need to design the solution.
Which three actions should you perform? Each correct answer presents part of the solution. NOTE: Each correct selection is worth one point.

- A. Use the Populate a Microsoft Word Online (Business) template action in a desktop flow.
- B. Create a cloud flow that uses the When a row is added or modified trigger in Microsoft Dataverse.
- C. Use the Populate a Microsoft Word Online (Business) template action in a cloud flow.
- D. Use the Convert Word Document to PDF and Send an email actions in a cloud flow.
- E. Use the Convert Word Document to PDF and Send an email actions in a desktop flow.

Answer: ABE

NEW QUESTION 71

- (Exam Topic 3)
You are developing a new release for an automation solution. You need to use the right feature.
Which feature should you use? To answer, select the appropriate options in the answer area. NOTE: Each correct selection is worth one point.

Answer Area

Scenario	Action
Upgrade a single cloud flow from a solution.	Clone a patch. Clone a solution. Export as managed solution. Export as unmanaged solution.
Release a new major version of a solution.	Clone a patch. Clone a solution. Export as managed solution. Export as unmanaged solution.
Synchronize solution components between development and production environments.	Update. Upgrade. Import as managed solution. Import as unmanaged solution.
Overwrite a solution in a production environment.	Update. Upgrade. Import as managed solution. Import as unmanaged solution.

- A. Mastered
- B. Not Mastered

Answer: A

Explanation:

Scenario	Action
Upgrade a single cloud flow from a solution.	Clone a patch. Clone a solution. Export as managed solution. Export as unmanaged solution.
Release a new major version of a solution.	Clone a patch. Clone a solution. Export as managed solution. Export as unmanaged solution.
Synchronize solution components between development and production environments.	Update. Upgrade. Import as managed solution. Import as unmanaged solution.
Overwrite a solution in a production environment.	Update. Upgrade. Import as managed solution. Import as unmanaged solution.

NEW QUESTION 74

- (Exam Topic 3)

A company has a business-critical desktop flow that runs on a single machine. The number of daily runs for the flow has significantly increased recently. Users report that the time required for the flow to complete is no longer acceptable. You need to scale the solution. Which four actions should you perform in sequence? To answer, move the appropriate actions from the list of actions to the answer area and arrange them in the correct order.

Actions

Update the cloud flow connection.

Sign into a machine and launch the Power Automate portal. Add the current machine to an existing group.

Sign into every other machine and add the machines to the group.

Launch the Power Automate machine runtime on one machine and add the machine to a group.

Provision new machines and install Power Automate for desktop on each machine.

Launch Power Automate for desktop on one machine and add the machine to a group.

Create a new group in the Power Automate portal and add all machines to the group.

Answer area

- A. Mastered
- B. Not Mastered

Answer: A

Explanation:

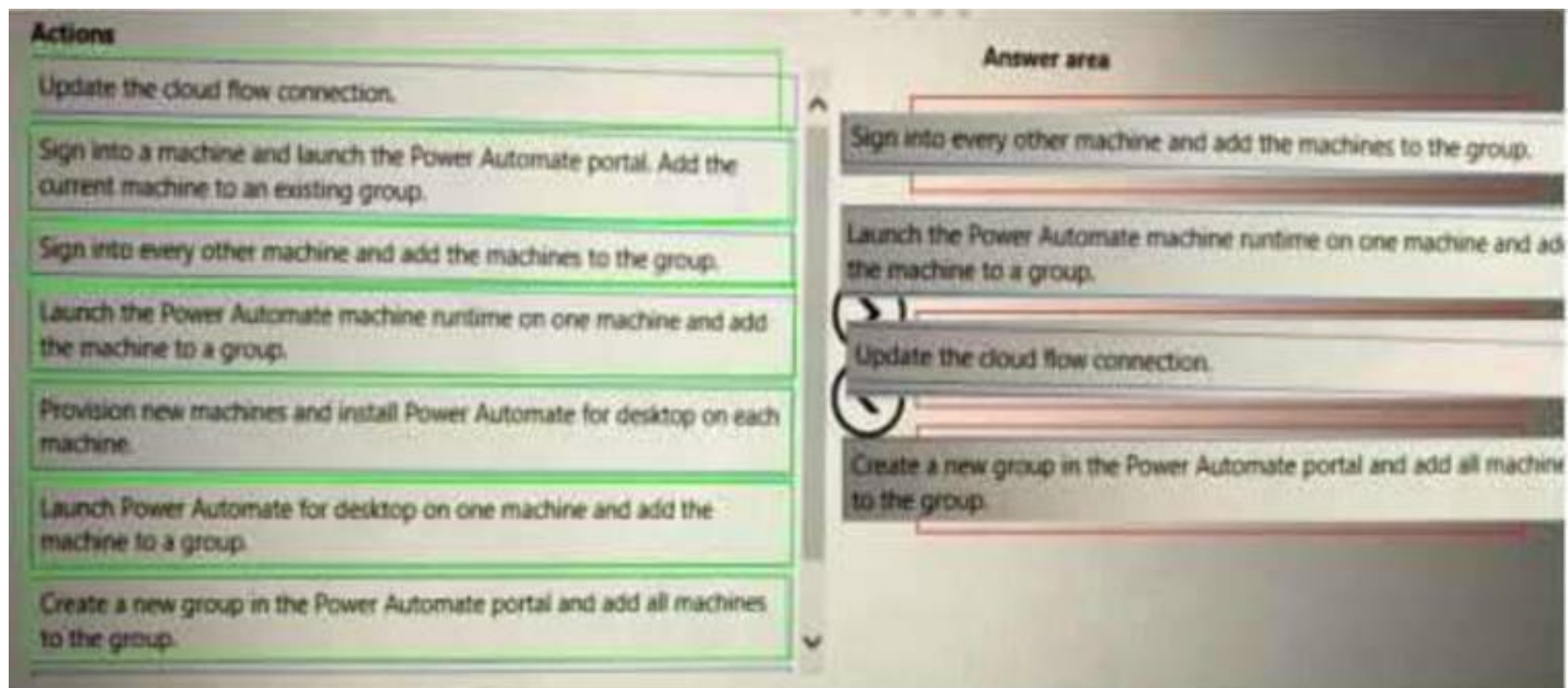

NEW QUESTION 76

- (Exam Topic 3)

You need to design automation solutions for a company.

What should you implement? To answer, select the appropriate configuration in the answer area. NOTE: Each correct selection is worth one point.

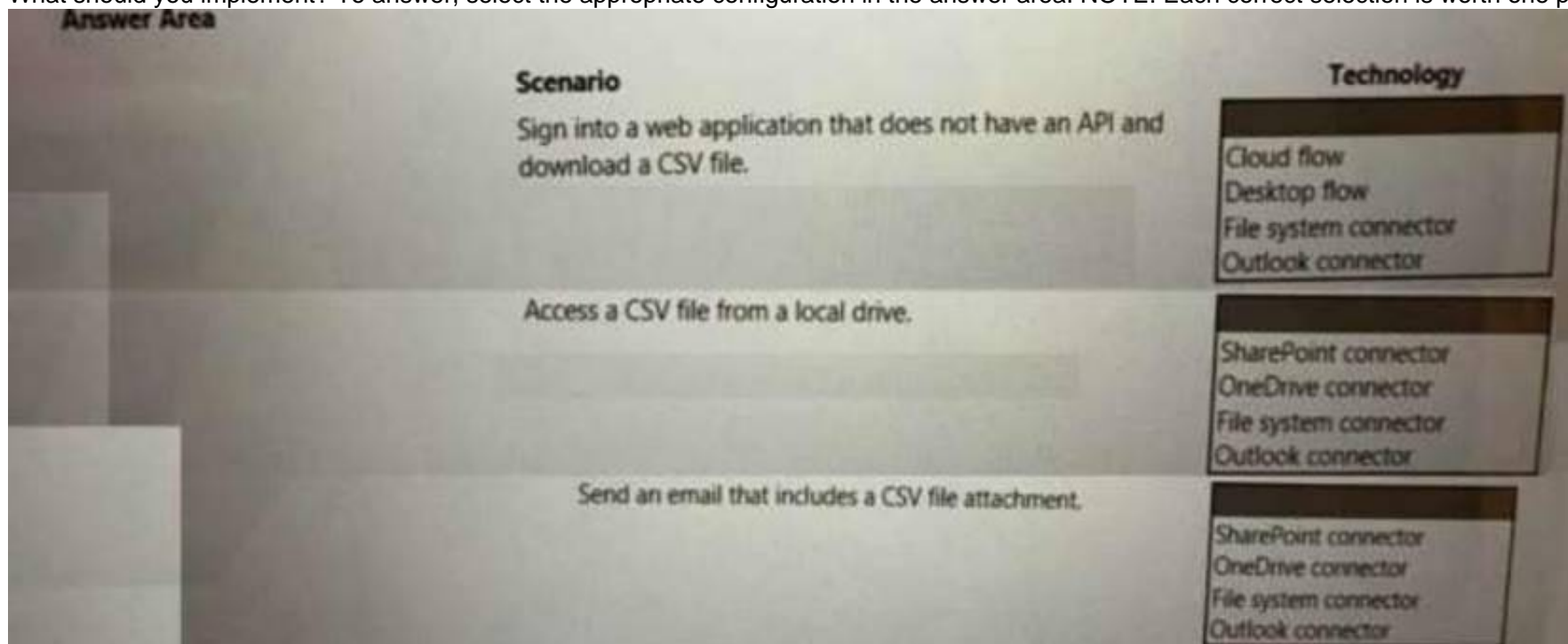

- A. Mastered
- B. Not Mastered

Answer: A

Explanation:

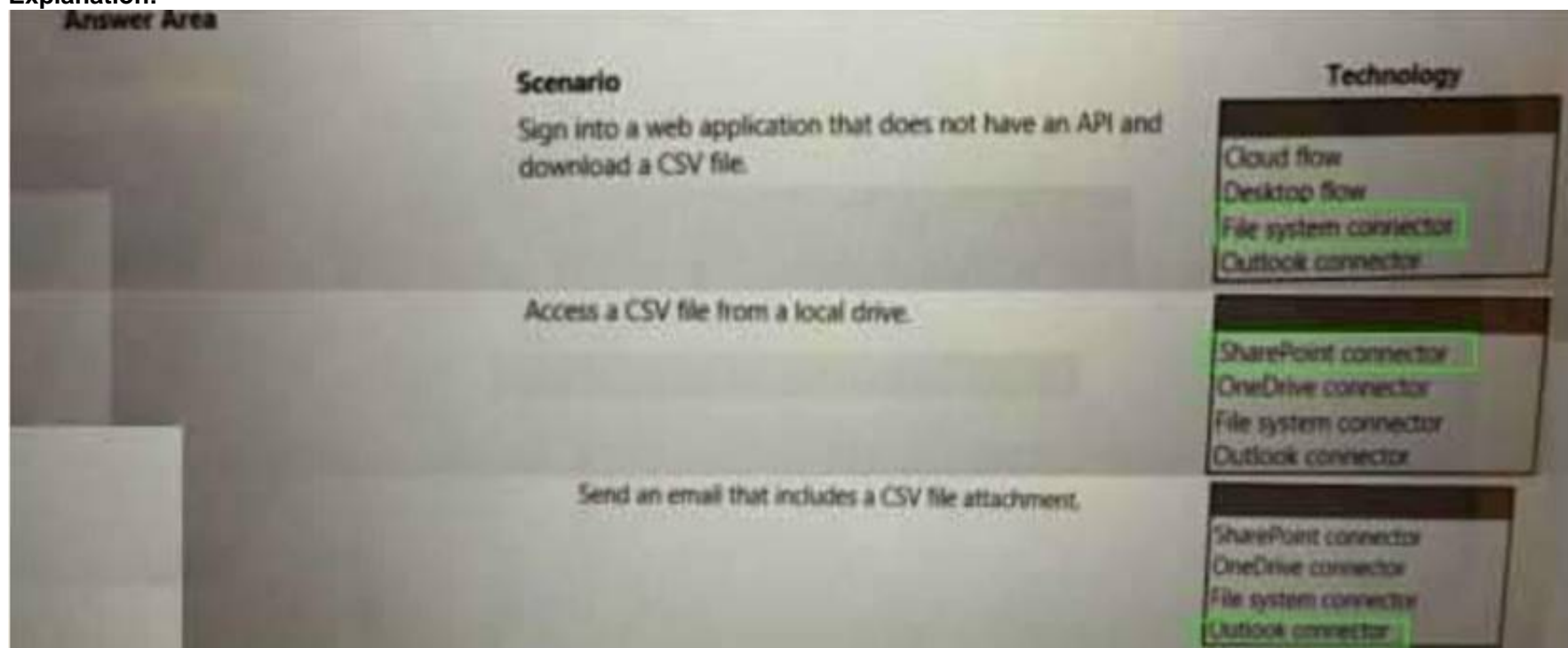

NEW QUESTION 79

- (Exam Topic 3)

You are creating a cloud flow that will use two Update Row actions to interact with Microsoft Dataverse. Neither of these actions are dependent on each other. You

must minimize the amount of processing time required to complete the flow. You need to implement the actions in the cloud flow.
Solution: Create two sequential Update Row actions. Does the solution meet the goal?

- A. Yes
- B. No

Answer: A

NEW QUESTION 81

- (Exam Topic 3)

You are developing a solution for a medical practice. The solution must use an artificial intelligence (AI) model to evaluate medical X-ray images and detect broken bones.

You need to create the AI model for the solution. Solution: Use Azure machine learning to create the model. Does the solution meet the goal?

- A. Yes
- B. No

Answer: B

NEW QUESTION 85

- (Exam Topic 3)

You create a solution within a Microsoft Power Platform environment. The environment includes all connections required for the solution.

You need to create a connection reference for the flows.

Which four actions should you perform in sequence? To answer, move the appropriate actions from the list of actions to the answer area and arrange them in the order.

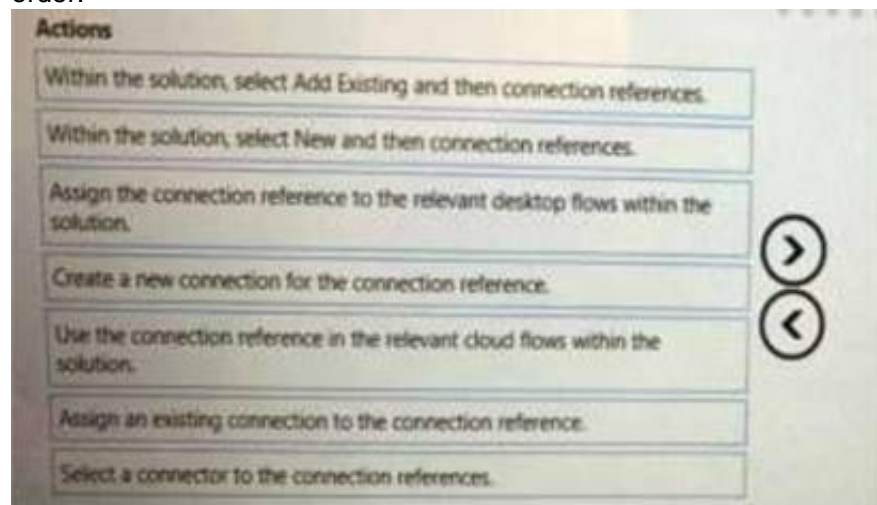

- A. Mastered
- B. Not Mastered

Answer: A

Explanation:

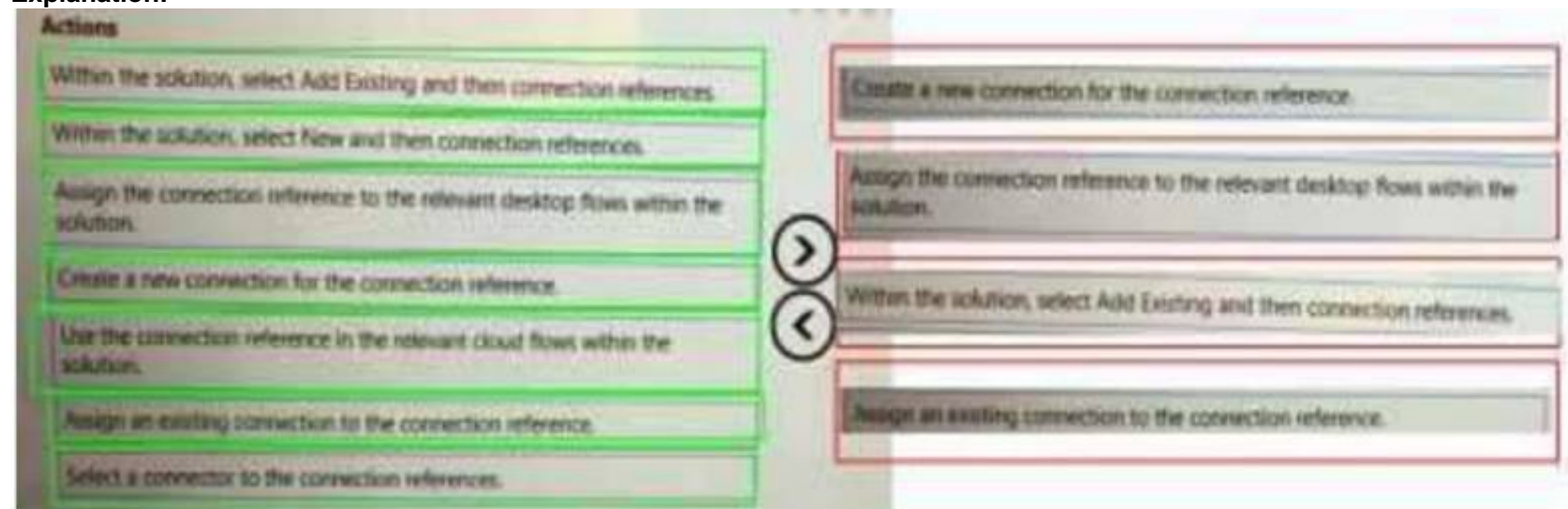

NEW QUESTION 86

- (Exam Topic 3)

A company stores confidential documents in a SharePoint document library.

A developer must create an automation solution in a default environment that processes documents from the SharePoint library and uploads approved documents to Azure File Storage for archiving purposes. The automation must meet the following requirements:

- Prevent modification or deletion of approved documents from Azure File Storage.
- Prevent sharing of documents from SharePoint or Azure File Storage. You need to configure a data loss prevention (DLP) policy.

Which five actions should you perform in sequence? To answer, move the appropriate actions from the list of actions to the answer area and arrange them in the correct order.

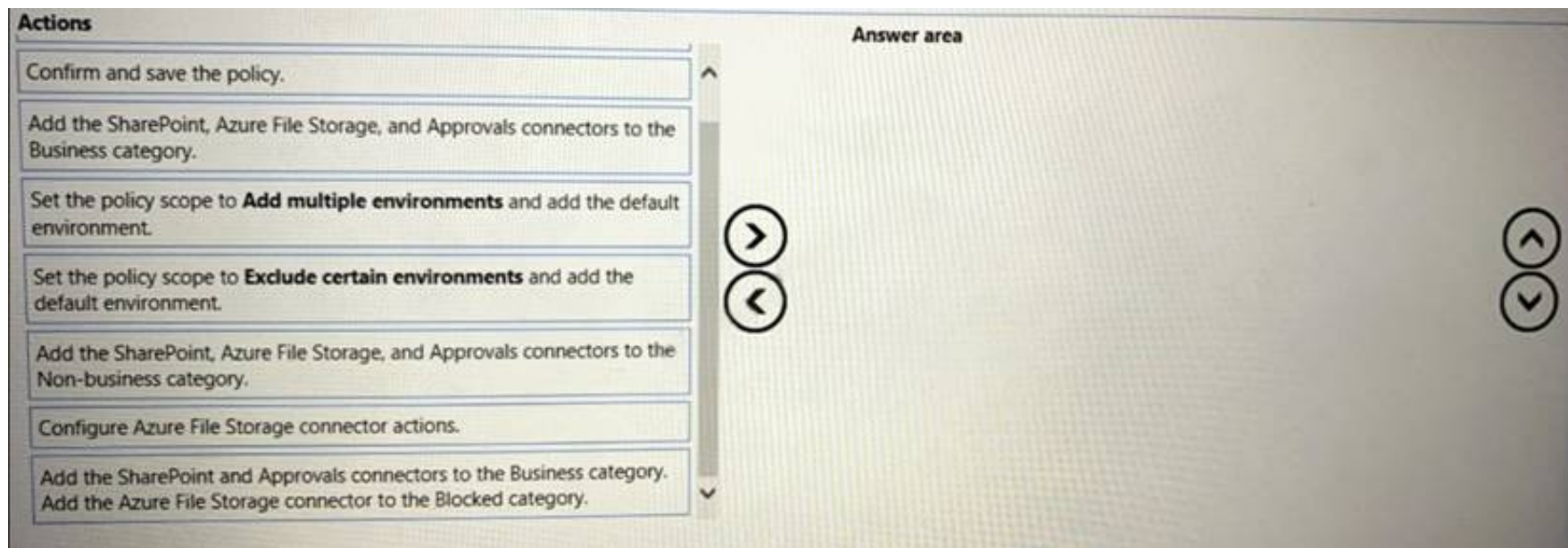

- A. Mastered
- B. Not Mastered

Answer: A

Explanation:

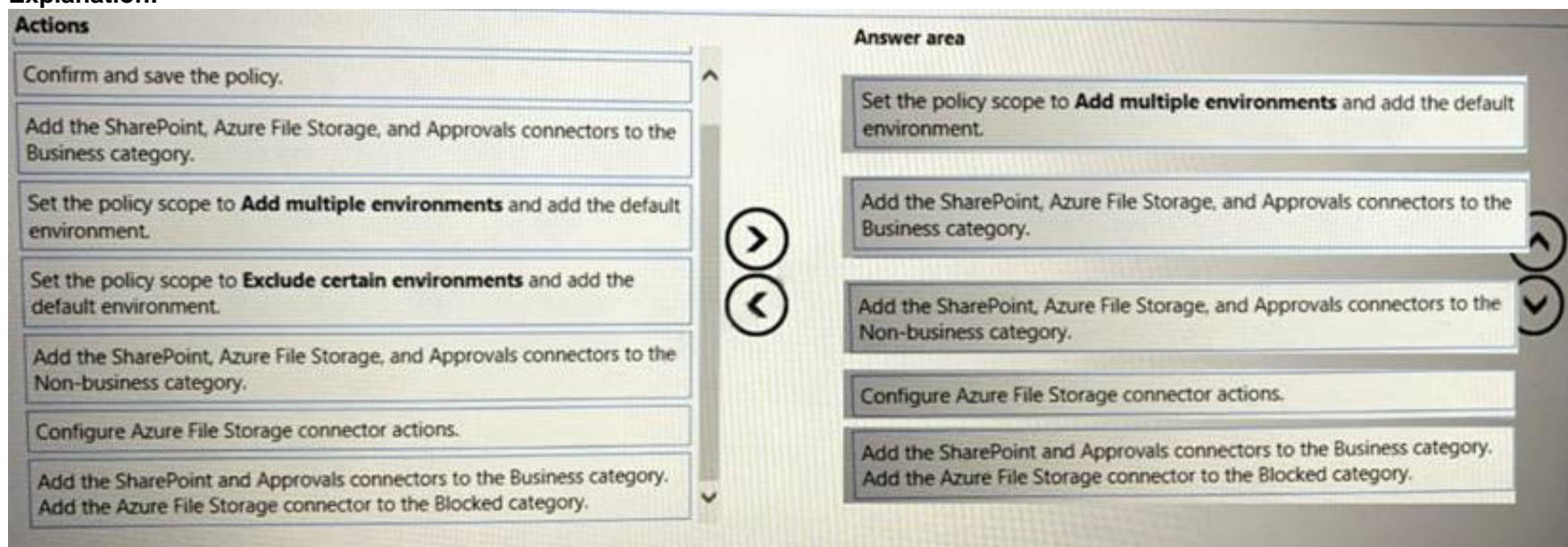

NEW QUESTION 88

.....

Thank You for Trying Our Product

* 100% Pass or Money Back

All our products come with a 90-day Money Back Guarantee.

* One year free update

You can enjoy free update one year. 24x7 online support.

* Trusted by Millions

We currently serve more than 30,000,000 customers.

* Shop Securely

All transactions are protected by VeriSign!

100% Pass Your PL-500 Exam with Our Prep Materials Via below:

<https://www.certleader.com/PL-500-dumps.html>